

Product Description

- ◆ Material: 6063-T5
- ◆ Surface treatment: Anode Oxidation (Natural color)
- ◆ Suitable for KSI series panel mounted SSR
- ◆ Available with screw or 35mm Din-rail installation

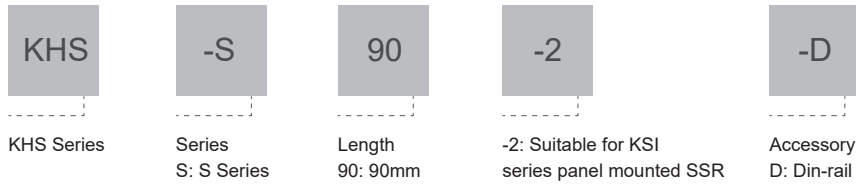

Ordering Information



General Specifications

Series	S Series
Part Number	KHS-S90
Photo	
Material	6063-T5
Thermal Resistance	1.3 C/W
Net Weight(Typical)	410g
Outer Dimension	45.5mm×91.5mm×125mm
Installation mode	screw or 35mm Din-rail
Suitable for	SSR with mounting hole spacing of 47.5mm, such as KSI series

Outline Dimensions

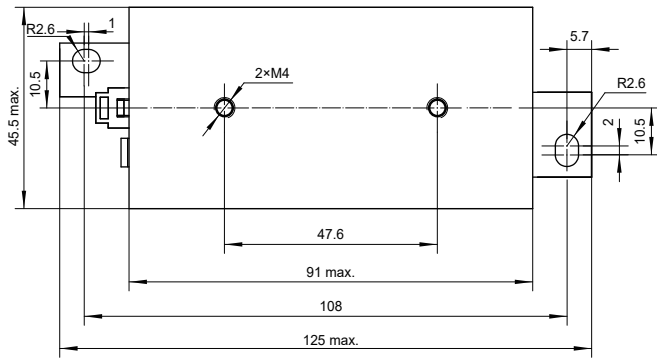
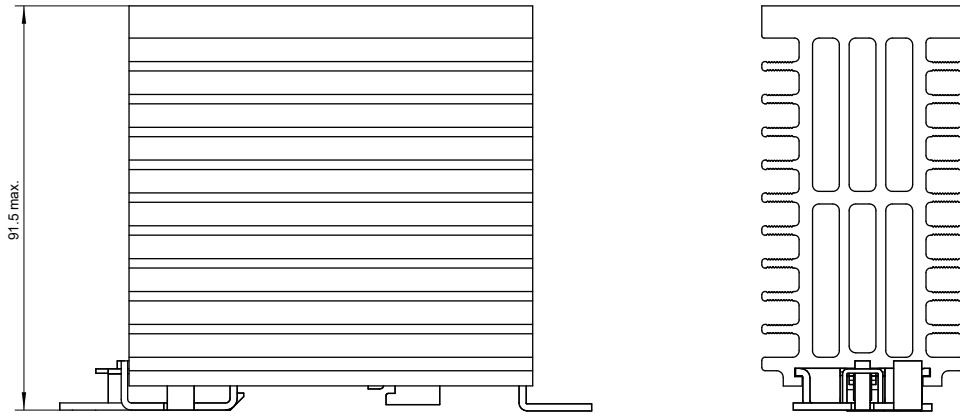

KHS-S90-2-D